

# Oneida County Forest

Tract #18-17

Town of Lynne

Contractor: \_\_\_\_\_

Contract # \_\_\_\_\_

Date Sold: \_\_\_\_\_

Date Completed: \_\_\_\_\_

2 Year Contract

Compartments/Stands: 66/4, 71/10, 72/11  
 Sale Area: 40 Acres  
 T36N R4E Sec.12 W1/2NE, SENW, NESW  
 T36N R5E Sec.6 W1/2NE

## Black Cat

Approximate  
Sale Location

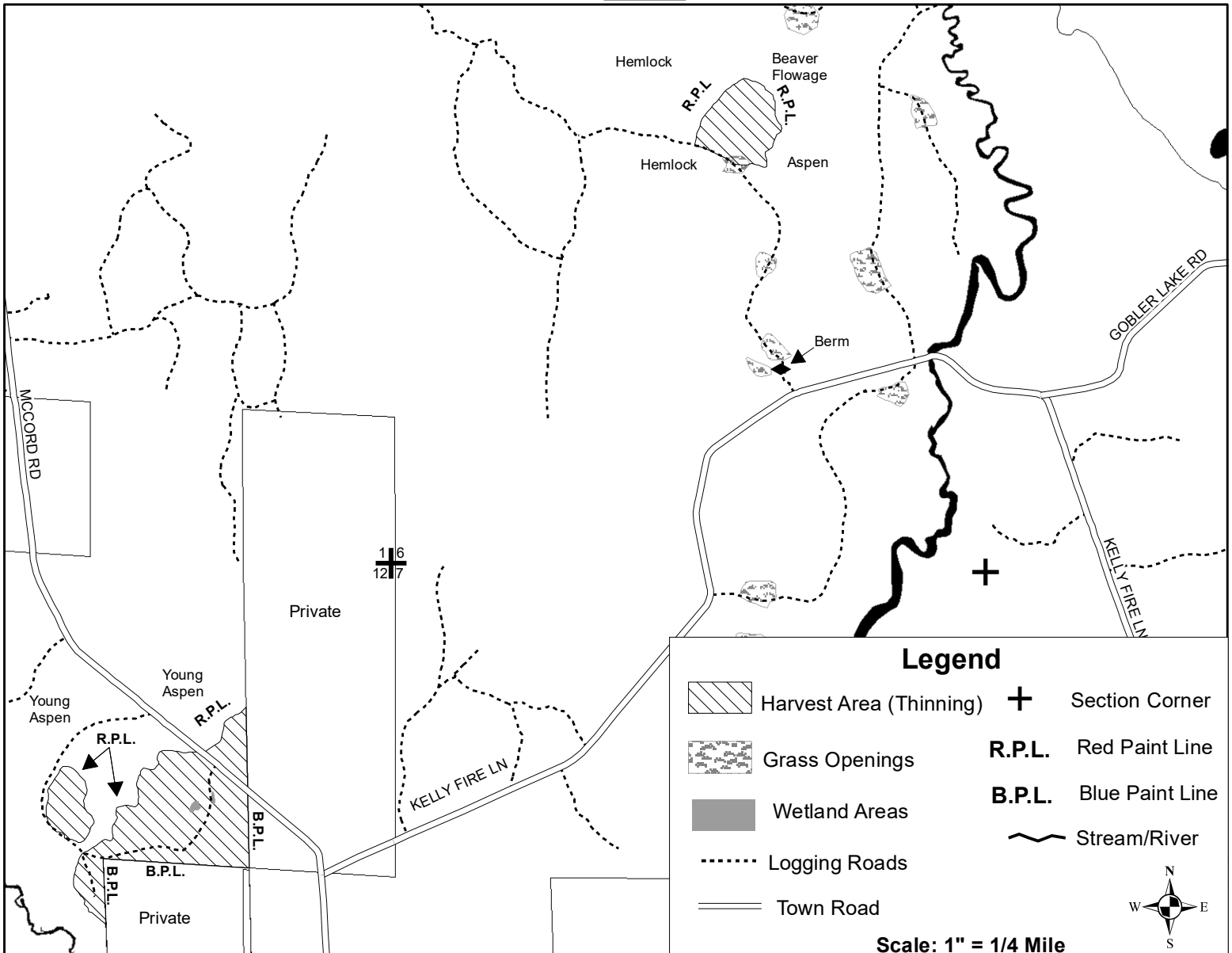

4" Top	Est. Vol.	Min. Bid
Mixed Hardwood*	330 Tons (134 cd)	\$10.80/T
Balsam Fir	25 Tons (10 cd)	\$4.40/T
Basswood	30 Tons (16 cd)	\$2.60/T

\*Mx Hwd = 67% H.Maple, 31% R.Maple and 2% ash.

Whole Tree	Est. Vol.	Min. Bid
Mixed Hardwood*	435 Tons (177 cd)	\$8.19/T
Balsam Fir	30 Tons (14 cd)	\$3.67/T
Basswood	40 Tons (21 cd)	\$1.95/T

\*Mx Hwd = 67% H.Maple, 31% R. Maple and 2% ash.

Sawtimber	Est. Vol.	Min. Bid
Mixed Hardwood^	37.0 MBF	\$123.00 / MBF
Hard Maple	13.0 MBF	\$220.00 / MBF

Mixed Hardwood^ = 54% basswood, 37% red maple and 9% ash.

**Regulations  
See Page 2**



# Oneida County Forest Black Cat

Tract #18-17

Town of Lynne

Compartments/Stands: 66/4, 71/7, 72/11

Sale Area: 40 acres

T36N R4E Sec.12 W1/2NE, SENW, NESW

T36N R5E Sec. 6 W1/2NE

Contractor: \_\_\_\_\_

Contract #: \_\_\_\_\_

Date Sold: \_\_\_\_\_

Date Completed: \_\_\_\_\_

2 Year Contract

<b>4" Top</b>	<b>Est.Vol.</b>	<b>Min.Bid</b>	<b>Whole Tree</b>	<b>Est.Vol.</b>	<b>Min.Bid</b>
Mixed Hardwood <sup>1</sup>	330 Tons (134 cd)	\$10.80/T	Mixed Hardwood <sup>1</sup>	435 Tons (177 cd)	\$8.19/T
Balsam Fir	25 Tons (10 cd)	\$4.40/T	Balsam Fir	30 Tons (14 cd)	\$3.67/T
Basswood	30 Tons (16 cd)	\$2.60/T	Basswood	40 Tons (21 cd)	\$1.95/T

Mixed Hardwood<sup>1</sup>=67% hard maple, 31% red maple and 2% ash.

<b>Sawtimber</b>	<b>Est.Vol.</b>	<b>Min.Bid</b>
Mixed Hardwood <sup>2</sup>	37.0 MBF	\$123.00/MBF
Hard Maple	13.0 MBF	\$220.00/MBF

Mixed Hardwood<sup>2</sup>=54% basswood, 37% red maple and 9% ash.

**Additional Regulations:**

1. Harvest all balsam fir and ironwood 1 inch and larger along with all orange marked trees. Leave all cherry, yellow birch, hemlock, spruce and cedar. Utilization on all species is 100" stick to a 4" top or whole tree. If harvesting whole tree, 1 in 10 tops above the standard 4" diameter must be left evenly scattered in the harvest areas. Standing dead trees are not to be cut unless they pose a safety hazard.
2. Logging operations are limited to the period from July 15 to spring breakup and only when ground is dry or frozen to prevent rutting. Additional time restrictions may be imposed if excessive rutting occurs in the woods, on the roads or if excessive damage to the residual trees occur. If, in the opinion of the County, excessive damage to the residual stand cannot be avoided by the contractor, additional harvesting restrictions will be imposed or the contract may be cancelled.
3. Any trees felled across the blue paint lines must be pulled back into the cutting area before limbing and bucking.
4. No whole tree skidding. Trees must be topped and limbed at the felling site. Care must be taken to protect existing hardwood regeneration. If excessive damage to regeneration occurs, further restrictions may be imposed (fixed head only, no hotsaws).
5. No equipment may be operated within 15 feet of the wetland areas adjacent to or within the sale unless ground is frozen and no slash may be left in them. Slash must be pulled back a minimum of 25' from McCord Rd and all slash within 50' of McCord Rd shall be cut to no higher than 2' above the ground.
6. Stump height shall not exceed 10" within the entire sale area.
7. All landing sites and roads must have permission of the County prior to construction. All roads and landings must be leveled and blocked with rocks, berms or gates at the end of each harvest season and at the end of the sale. Roads and trails must be left in as good or better condition at the end of each season and at the end of the sale. Existing grass openings may be used for landings. Grass openings must be leveled and clear of debris upon completion of sale operations. Bond money will not be returned until all road/landing work is completed. No decking or skidding on McCord Rd. without permission of the Town of Lynne.
8. All items listed in the Oneida County Timber Sale Contract apply. All applicable BMP's will be followed.

Sale Est: JR, PF 07/2017

See Map

Page 1