

# Oneida County Forest

## Royal Wulff

Tract #17-18  
Town of Woodboro

Compartments/Stands: 34/4  
Sale Area: 51 Acres (Includes 5 reserve acres)  
T36N R7E Sec.22 E1/2NW, NE1/4



Contractor: \_\_\_\_\_  
Contract # \_\_\_\_\_  
Date Sold: \_\_\_\_\_  
Date Completed: \_\_\_\_\_  
2 Year Contract

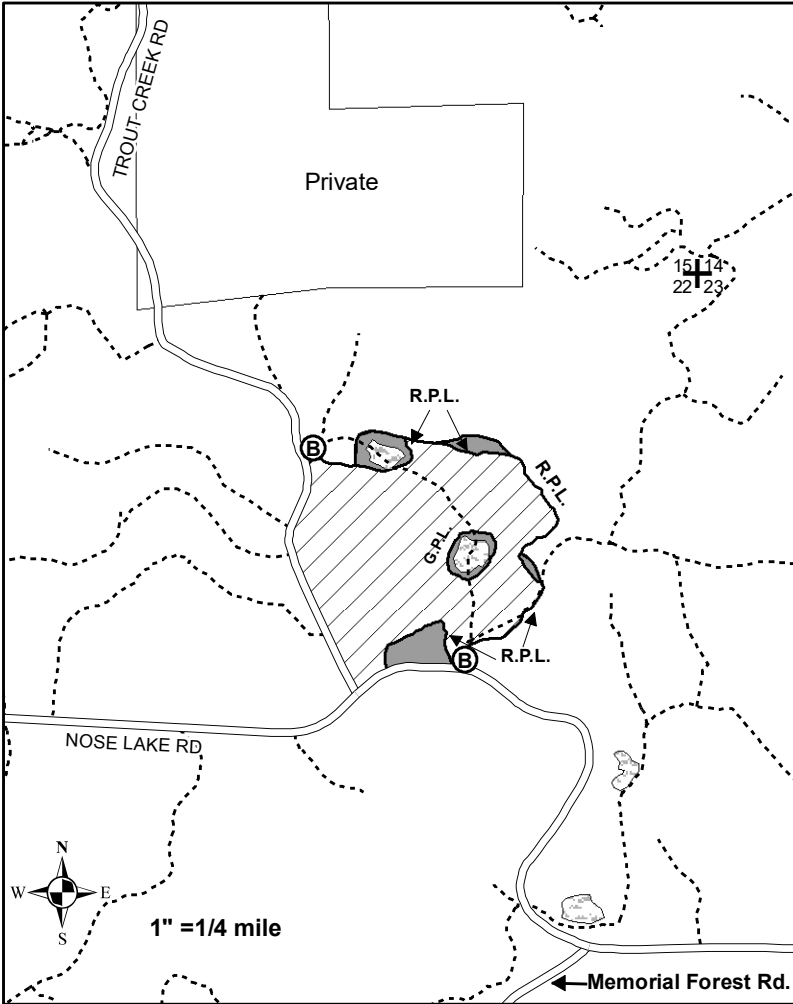

4" Top	Est. Vol.	Min. Bid
Aspen	2180 Tons (969 cd)	\$12.60/T
Mx Hardwood*	210 Tons (91 cd)	\$12.00/T
Mixed Hardwood* = 77% red maple, 21% white birch and 2% hard maple.		

Whole Tree	Est. Vol.	Min. Bid
Aspen	3055 Tons (1358 cd)	\$8.99/T
Mx Hardwood*	380 Tons (164 cd)	\$6.63/T
Mixed Hardwood* = 77% red maple, 21% white birch and 2% hard maple.		

### Legend

Coppice Harvest Area	<b>R.P.L.</b> Red Paint Line
Grass Opening	<b>G.P.L.</b> Green Paint Line
Town Road	<b>+</b> Section Corner
Reserve Areas	<b>.....</b> Woods Roads
	<b>(B)</b> Berm/Rocks

**Additional Regulations:**

- In coppice harvest area, harvest all 1" dbh and larger aspen, white birch, red maple and hard maple. Leave all cherry, spruce, oak, and pine. Utilization on all species is a 100" stick to a 4" top or whole tree. If harvesting whole tree, 1 in 10 tops above the standard 4" diameter must be left evenly scattered in the harvest areas. Standing dead trees are not to be cut unless they pose a safety hazard.
- Logging operations including road work, may take place only when the ground is dry or frozen so as to prevent rutting and soil compaction. Additional time restrictions may be imposed if excessive rutting occurs in the woods or on the roads.
- All trails and landings must have approval of the County prior to construction. Following completion of the sale, all trails will be returned to their original condition or better. All previously bermed access roads will be rocked or bermed off at the end of each harvest season and at the end of the sale. Bond money will not be returned until all road work is completed. Existing grass openings within the sale may be used for landings. Grass openings must be leveled and clear of debris upon completion of sale operations.
- Within reserves areas, equipment is only allowed on existing roads. Equipment and slash is not allowed in wetland areas within or adjacent to the harvest area.
- All slash must be cut to less than 2 ft high within 50 ft of Trout Creek Rd and Nose Lake Rd and must be pulled back 25 ft from the road. Decking on Trout Creek Rd and/or Nose Lake Rd may be allowed with permission from the Town of Woodboro. Wood decked along the road must be far enough off the road so as not to create a hazard to motor vehicles. Any damage to the road will be repaired by the contractor including grading and graveling if necessary.
- Stump height may not exceed 10".
- All items listed in the Oneida County Timber Sale Contract apply. All applicable BMP's will be followed.

Sale Est.:JR, PF, 3/18