

# Oneida County Forest

## Blind Aspen

Compartment / Stand 87/ 6  
 Harvest Area 46 Ac + 3 Ac Reserve  
 Legal Desc. T36N R4E Sec. 7 SESE  
 Sec. 8 SWSW. Sec. 17 W1/2NW  
 Sec. 18 E1/2NE

Approximate Sale Location  
 ★

Tract # 10-18  
 Town of Lynne  
 Contract No.: \_\_\_\_\_  
 Contractor: \_\_\_\_\_  
 Date Sold: \_\_\_\_\_  
 Date Completed: \_\_\_\_\_  
 Contract Length: 2 years

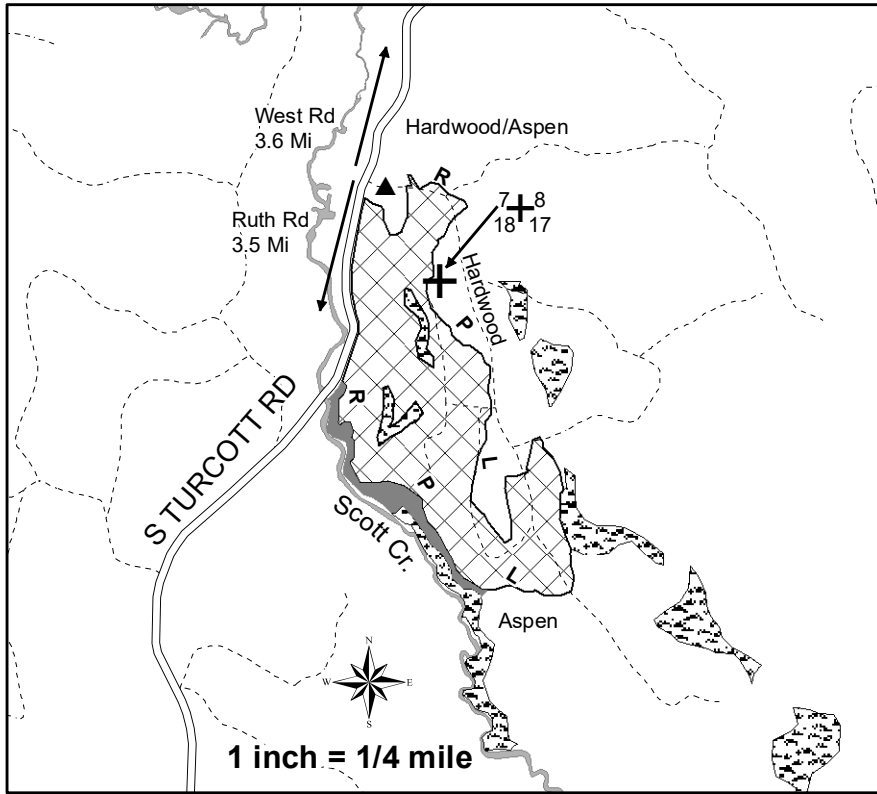

4" Top	Est. Volume	Min. Bid
Aspen	1190 Tons (529 cd)	\$12.00/Ton
*MX Hardwood	1235 Tons (504 cd)	\$12.00/Ton
Balsam	95 Tons (45 cd)	\$9.00/Ton
W Spruce	120 Tons (60 cd)	\$15.00/Ton
Whole Tree	Est. Volume	Min. Bid
Aspen	1575 Tons (700 cd)	\$9.07/Ton
*MX Hardwood	1420 Tons (580 cd)	\$10.44/Ton
Balsam	140 Tons (66 cd)	\$6.11/Ton
W Spruce	160 Tons (80 cd)	\$11.25/Ton

\*MX Hardwood Pulp contains approximately 20% Hard Maple, 65% Red Maple, 13% White Birch, 2%

Legend	
	Harvest Area
	Retention Area
	Tag Alder
	RPL Red Paint Line
	Section Corner
	Rocks/Berm
	Town Road

### Additional Regulations:

- In the Harvest Area cut all aspen, maple, white birch, ironwood, black ash and balsam fir 1' diameter and larger. Also, harvest only those white spruce 12" dbh to 18" dbh. Do not cut any other species. Utilization on all species is a 100" stick to a 4" top or whole tree. If harvesting whole tree, every 10th tree top above the 4" diameter must be left evenly scattered in the harvest area. Any den or nest trees shall be left uncut. Standing dead trees are not to be cut unless they pose a safety hazard.
- Dry or frozen ground conditions will be required for harvesting and hauling activities. Year round operations will be permitted as long as rutting or road damage does not occur. Time restrictions may be imposed if excessive rutting occurs in the woods or on the roads or if excessive damage to the residual trees occurs.
- No new roads will be permitted. Existing roads may be opened and improved and landing sites may be constructed with prior approval of the County. The main access trail must be blocked off with berms or rocks at the end of each harvest season and at the end of the sale. All trails will be returned to their original condition or better at the of sale. Bond money will not be returned until all road/landing rehabilitation is complete.
- Decking or skidding on S Turcott Rd will only be done with permission of the Town of Lynne and only when the road is dry or frozen to prevent damage. Wood decked along the road must be kept far enough off the road so as not to pose a danger to traffic.
- No equipment or slash is allowed in the wetland areas within or adjacent to the sale. Equipment may not be operated within 15 feet of any wetland unless ground is dry or frozen. NOTE: There are numerous seeps along the southwest red line adjacent to the Reserve Area. Caution should be used when operating in this area.
- Slash must be pulled back a minimum of 25 ft from the road edge and must be cut to no higher than 2 ft within 50 ft of the road. **NOTE: Reconstruction of S. Turcott Rd may occur during the time of this contract.** Contractor should contact the Town of Lynne to find out if and when road construction will occur.
- All items listed in the Oneida County Timber Sale Contract apply. All applicable BMP's will be followed. Sale Est. PF/MO 12/17