

# Oneida County Forest

Tract #9-18  
Town of Cassian

## Rice Creek Redds

Compartments/Stands: 50/6  
Sale Area: 46 Acres  
T37N R7E Sec.27 N1/2SW, SESW,  
W1/2SE, SENW, NE1/4

Approximate  
Sale Location



Contractor: \_\_\_\_\_  
Contract # \_\_\_\_\_  
Date Sold: \_\_\_\_\_  
Date Completed: \_\_\_\_\_  
2 Year Contract

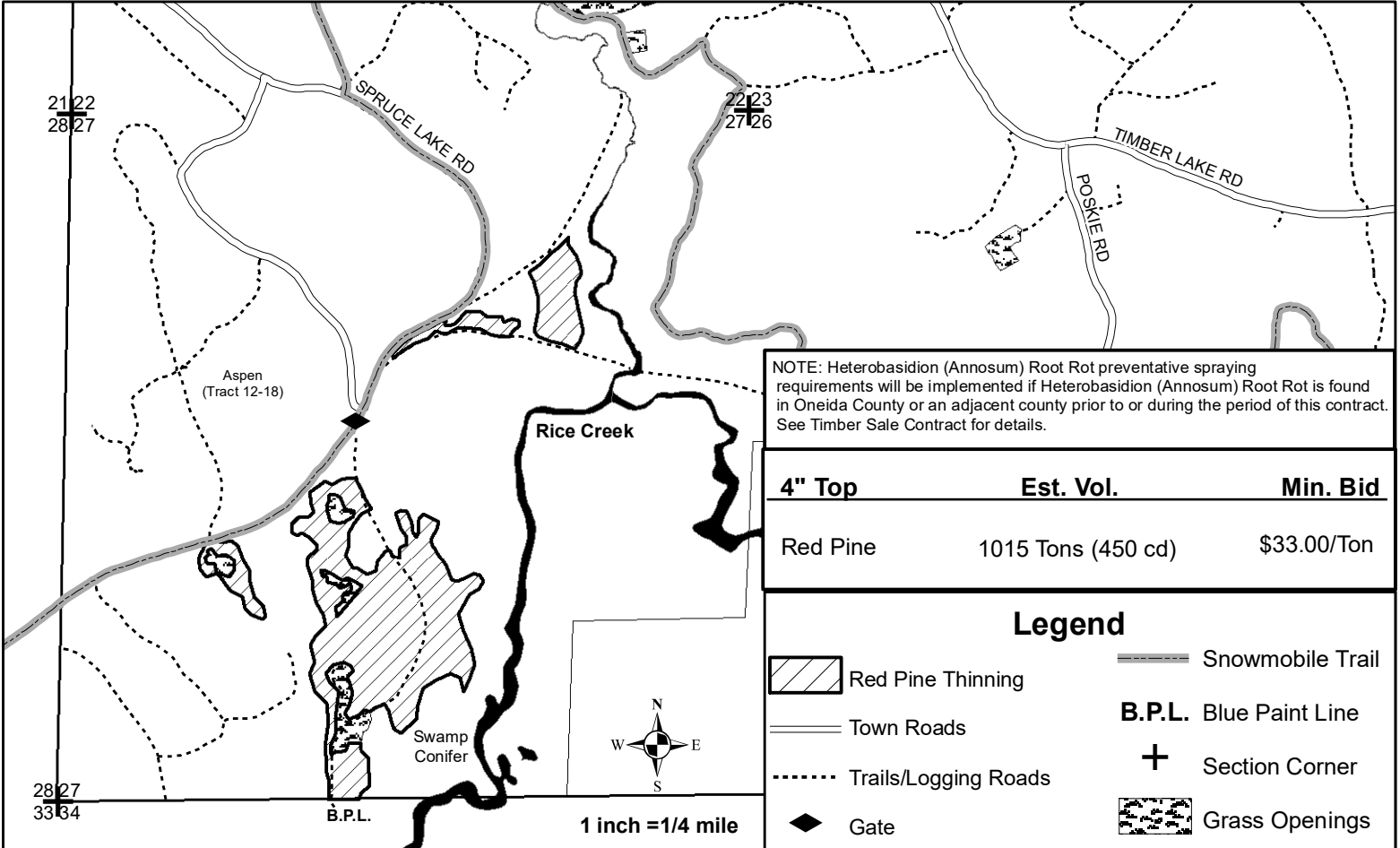

### Additional Regulations:

- In the red pine thinning, harvest all orange marked red pine, leaving orange paint visible on the stump. Utilization on all species is a 100" stick to a 4" top. No whole tree utilization is allowed in this sale. Standing dead trees are not to be cut unless they pose a safety hazard.
- All pine harvested from April 1 through August 15 must be hauled within two weeks. Logging operations are allowed year round as long as the ground is dry or frozen to prevent rutting. Additional time restrictions may be imposed if excessive rutting occurs in the woods, on the roads or if excessive damage to the residual trees occur. If, in the opinion of the County, excessive damage to the residual stand cannot be avoided by the contractor, additional harvesting restrictions will be imposed or the contract may be cancelled.
- Any trees felled across blue paint lines must be pulled back into the cutting area before limbing and bucking.
- Landings must have approval of the County prior to construction. No new roads will be allowed. Following completion of the sale, all trails will be returned to their original condition or better. All previously bermed access roads will be rocked or bermed off at the end of each harvest season and at the end of the sale. If snowmobile trail is used for sale operations while the trail is open, trail must remain snow-covered and in a safe, usable condition with equipment and logging material parked far enough off the trail to ensure public safety. If snowmobile trail is used while trail is closed, gates must be closed and locked during periods of inactivity. Bond money will not be returned until all road work is completed. Existing grass openings within the sale may be used for landings. Grassy openings must be leveled and clear of debris upon completion of sale operations.
- No whole-tree skidding is allowed. Trees must be topped and limbed at the felling site. Maximum pole skidding length is 18'. Utility poles will be dealt with on a case-by-case basis.
- All slash must be cut to less than 2 ft high within 50 ft of Spruce Lake Rd and must be pulled back 25 ft from the road. Decking on Spruce Lake Rd may be allowed with permission from the Town of Cassian. Wood decked along the road must be far enough off the road so as not to create a hazard to motor vehicles. Any damage to the road will be repaired by the contractor including grading and graveling if necessary.
- Stump height may not exceed 10".
- All items listed in the Oneida County Timber Sale Contract apply. All applicable BMP's will be followed.

Sale Est.:JR, PF, 12/17