

# Oneida County Forest Don't Thin Aspen

Compartment / Stand 42/ 6  
Harvest Area 81 Ac + 7 Ac Reserve  
Legal Desc. T36N R6E Sec. 25 SW1/4,  
W1/2 of SE1/4, NWNW, SWNW, SENW

Approximate Sale  
Location



Tract # 7-18  
Town of Nokomis  
Contract No.: \_\_\_\_\_  
Contractor: \_\_\_\_\_  
Date Sold: \_\_\_\_\_  
Date Completed: \_\_\_\_\_  
Contract Length: 2 years

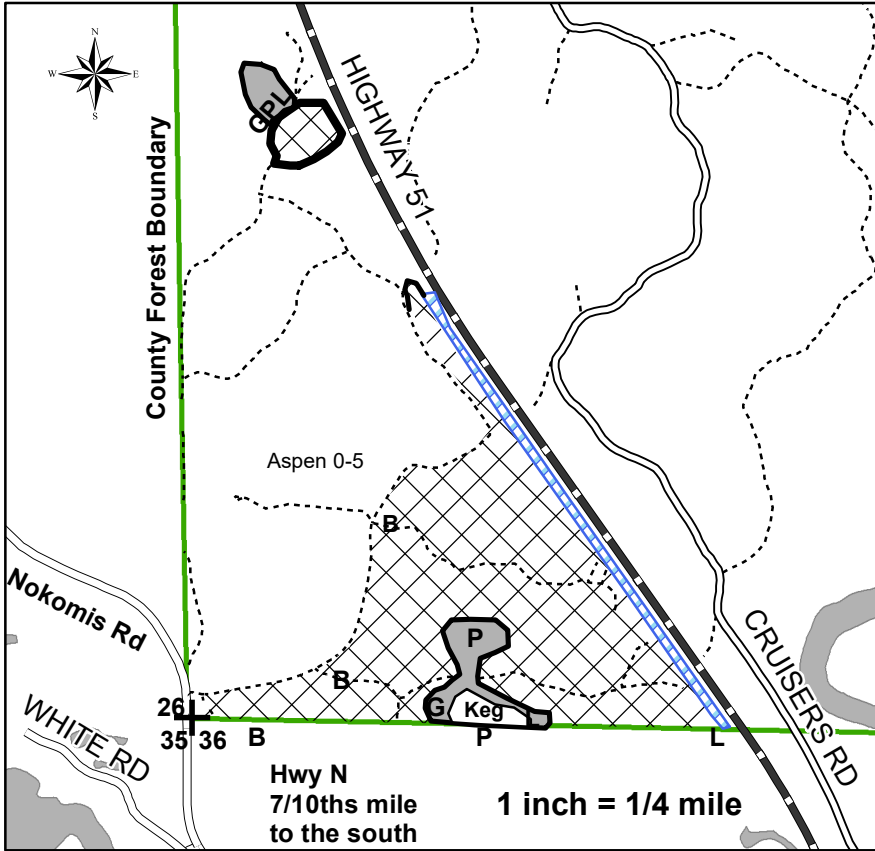

4" Top	Est. Volume	Min. Bid
Aspen	3240 Tons (1440 cd)	\$13.00/Ton
*MX Hardwood	275 Tons (118 cd)	\$12.40/Ton
Jack Pine	30 Tons (14 cd)	\$15.00/Ton
Oak	420 Tons (153 cd)	\$11.90/Ton

Whole Tree	Est. Volume	Min. Bid
Aspen	4250 Tons (1889 cd)	\$9.91/Ton
*MX Hardwood	450 Tons (193 cd)	\$7.58/Ton
Jack Pine	40 Tons (19 cd)	\$11.25/Ton
Oak	645 Tons (235 cd)	\$7.75/Ton

\*MX Hardwood Pulp contains approximately 5% Hard Maple, 50% Red Maple, 45% White Birch  
Jack Pine may include 5% of Balsam Fir.

Legend	
	Harvest Area
	Retention Area
	DOT-ROW
	B Berm
	BPL Blue Paint Line
	GPL Green Paint Line
	Section Corner
	Logging Road
	Town Road

### Additional Regulations:

- In the Harvest Area cut all aspen, maple, white birch, non-yellow marked oak, ironwood, jack pine and balsam fir 1' diameter and larger. Do not cut any other species. Do not cut bur or white oak or yellow-marked oak. Utilization on all species is a 100" stick to a 4" top or whole tree. If harvesting whole tree, every 10th tree top above the 4" diameter must be left evenly scattered in the harvest area. Any den or nest trees shall be left uncut. Standing dead trees are not to be cut unless they pose a safety hazard. Damage to established regeneration shall be minimized.
- Year round operations will be permitted for harvesting, skidding and hauling as long as rutting or road damage does not occur. Time restrictions may be imposed if excessive rutting occurs in the woods or on the roads or if excessive damage to the residual trees occurs.
- No new roads will be permitted. Existing roads may be opened and improved and landing sites may be constructed with prior approval of the County. All side access trails from the main access road must be blocked off with berms or rocks at the end of each harvest season and at the end of the sale. The main road may be left open. All trails will be returned to their original condition or better at the end of the sale. Bond money will not be returned until all road/landing rehabilitation is complete.
- Decking or skidding on any Town Roads will not be necessary. Wood decked near the road must be kept far enough off the road so as not to pose a danger to traffic.
- No equipment or slash is allowed in the wetland areas within or adjacent to the sale. Equipment may not be operated within 15 feet of any wetland unless ground is dry or frozen. Stay out of Retention Areas.
- Slash must be pulled back a minimum of 25 ft from the Town road edge and main access road and must be cut to no higher than 2 ft within 50 ft of the roads.
- All items listed in the Oneida County Timber Sale Contract apply. All applicable BMP's will be followed. Sale Est. ER 2/18
- DOT wants County/Logger to cut ~2 acre ROW adjacent to the sale. As long as the logger agrees, they can cut all merchantable Aspen within 2-acre ROW. All other species on the east side of the fence will not be cut. To harvest timber within the ROW, the logger has permission to cut at least two openings in the fence to go in and out of to cut, skid and haul. DOT wood must be kept separate and all stumpage will be paid to OCF. This small portion of timber can be scaled on the landing.