

# Oneida County Forest

Tract # 3-18  
Town of Lynne

Compartment/Stand: 107/17 & 108/15  
Sale Area: 63 Ac: 32 Ac West, 31 Ac East  
Sec. 13: NESW, W1/2SE, SESE  
Sec. 14: SESW, SWSE  
Sec. 23: NENW, NWNE  
of T37N R4E

## McFalls Pine

Contractor: \_\_\_\_\_  
Contract # \_\_\_\_\_  
Date Sold: \_\_\_\_\_  
Date Completed: \_\_\_\_\_  
2 Year Contract

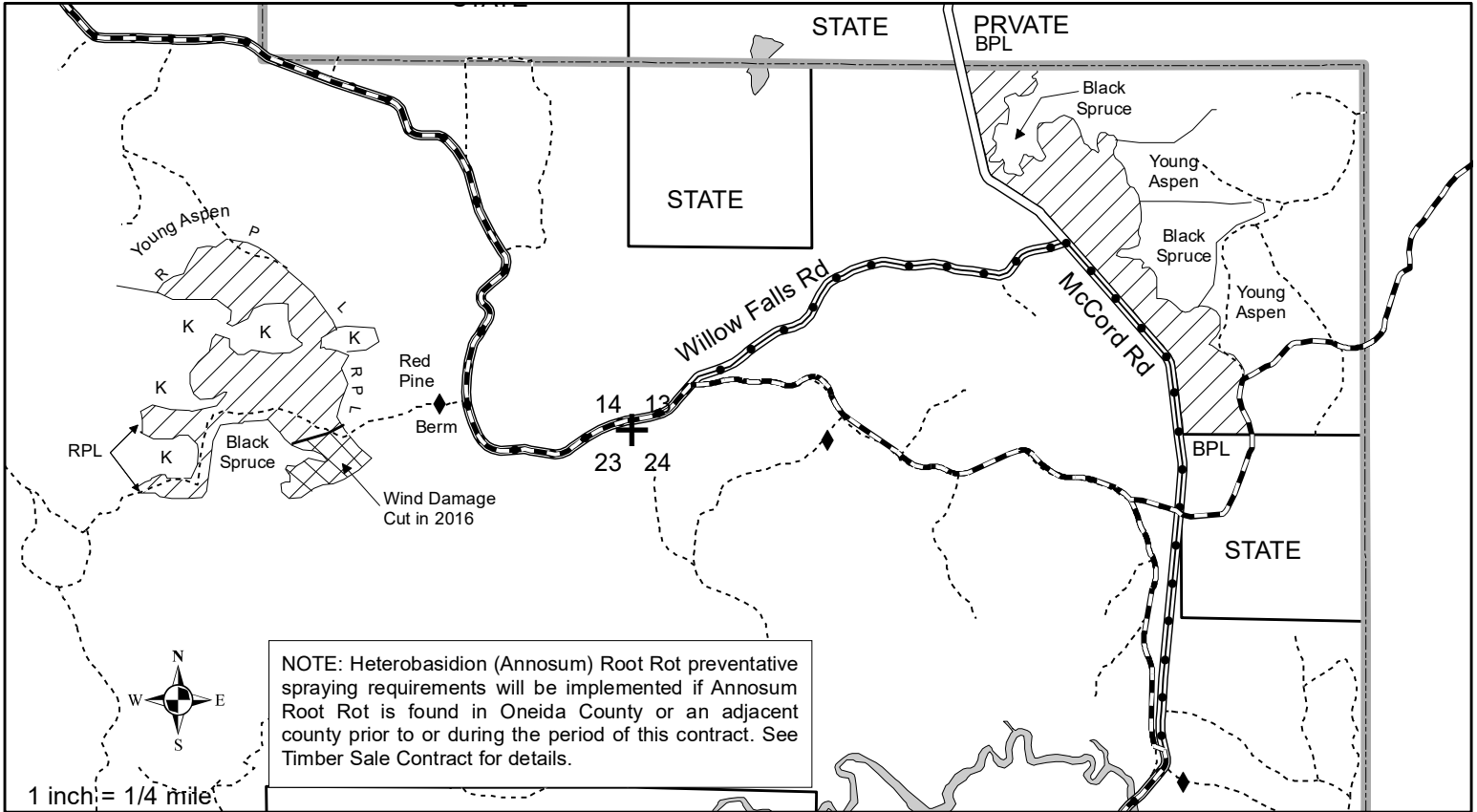

NOTE: Heterobasidion (Annosum) Root Rot preventative spraying requirements will be implemented if Annosum Root Rot is found in Oneida County or an adjacent county prior to or during the period of this contract. See Timber Sale Contract for details.

### Legend

- Sale Areas
- RPL Red Paint Line
- BPL Blue Paint Line

- Logging Roads
- ATV Route
- Snowmobile Trail

- K** Keg
- +** Section Corner

4" Top	Est. Vol.	Min. Bid
Red Pine*	1675 Tons (744 cd)	\$30.00/T
*96% Red Pine, 3% White Pine, 1% Jack Pine		

### Additional Regulations:

1. In the Sale Areas only harvest trees marked with orange paint, leaving orange visible on the stump. No whole tree utilization. Utilization is 100" stick to a 4" top. Standing dead trees are not to be cut unless they pose a safety hazard. Year-round harvesting is permitted when ground is dry or frozen. All pine harvested from April 1 to August 15 must be hauled within 2 weeks.
2. No whole tree skidding. Trees must be topped and limbed at the felling site. Maximum pole skidding length is 18'. Utility poles will be dealt with on a case-by-case basis.
3. All trails and landings must have approval of the County prior to construction. Following completion of the sale, all trails will be returned to their original condition or better. All access roads will be rocked or bermed off at the end of each harvest season and at the end of the sale. Bond money will not be returned until all road work is completed.
4. No equipment is allowed in the swampy, tag alder, wet-keg areas adjacent to or within the sale except when ground is frozen. All slash must be removed from these areas. Any trees felled across the blue paint lines must be pulled back into sale area prior to limbing.
5. Stump height may not exceed 10".
6. Slash must be pulled back 25 feet from town roads and must be cut to no higher than 2 ft within this zone. No decking or skidding on any town roads without permission of the town. Caution signs must be installed on McCord/Willow Falls Rds while sale is active.
7. All items listed in the Oneida County Timber Sale Contract apply. All applicable BMP's will be followed.