

# Oneida County Forest

Tract #22-17  
Town of Woodboro

Compartments/Stand:

28/6 and 30/18

Sale Area: 87 Ac: 73 Cut, 14 Reserve

T36N R7E Sec.1 SE1/4, SENE, W1/2SW

Sec.12 NWNW

## Washburn Phase 3

Approximate  
Sale Location



Contractor: \_\_\_\_\_

Contract # \_\_\_\_\_

Date Sold: \_\_\_\_\_

Date Completed: \_\_\_\_\_

2 Year Contract

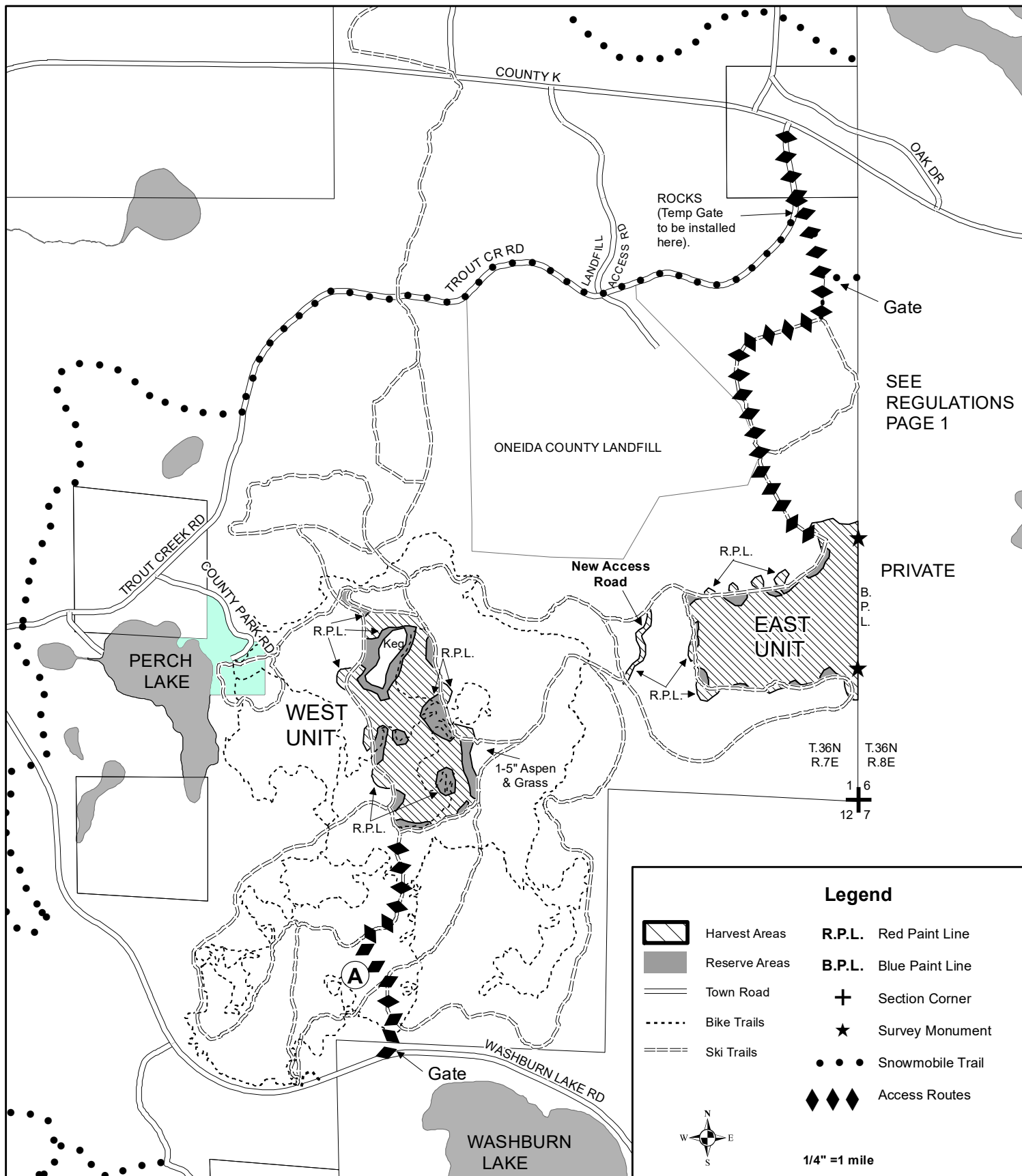

Compartments/Stand:  
28/6 and 30/18

Sale Area: 87 Ac: 73 Cut, 14 Reserve  
T36N R7E Sec.1 SE1/4, SENE, W1/2SW  
Sec.12 NWNW

# Oneida County Forest

## Washburn Phase 3

Tract #22-17  
Town of Woodboro

Contractor: \_\_\_\_\_  
Contract # \_\_\_\_\_  
Date Sold: \_\_\_\_\_  
Date Completed: \_\_\_\_\_  
2 Year Contract



4" Top	Est. Vol.	Min. Bid
Aspen	3610 Tons (1604 cd)	\$10.90/T
Whole Tree	Est. Vol.	Min. Bid
Aspen	5055 Tons (2247 cd)	\$7.78/T

### Legend

	Harvest Areas	<b>R.P.L.</b>	Red Paint Line
	Reserve Areas	<b>B.P.L.</b>	Blue Paint Line
	Town Road	<b>+</b>	Section Corner
	Bike Trails	<b>★</b>	Survey Monument
	Ski Trails	<b>• • • •</b>	Snowmobile Trail

**1/4" = 1 mile**

**SEE MAP PAGE 2**

#### HARVEST REGULATIONS

1. In the Harvest areas harvest all Aspen 1" diameter and larger, Do not cut any other species. No harvesting in Reserve Areas. All harvest areas outside the main part of the sale have red paint lines around them. All reserve areas within the sale have red paint lines around them. New Access Rd: This 100 ft wide strip is to have all trees harvested within the red paint lines. The yellow painted trees are the approximate center line of the new road.

Logging activities are limited to the period from July 15 (oak wilt) through November 15 (ski season preparation) and only when the ground is dry enough to prevent rutting.

Decking is permitted along the ski trails and in the grassy area on the south end of the west unit. Skidding on the ski trails is to be minimized to the extent possible. Landings and turn-arounds must have approval of the County prior to construction.

2. Utilization is 100" stick to a 4" top or as bid. If harvesting whole tree, 1 in 10 tree tops above the standard 4" top must be left on site and evenly scattered throughout the sale. Once operations start in one area, it must be completed before moving to another area.

3. ACCESS: Access to the EAST Unit is via Trout Creek Rd and the snowmobile/ski trails. Access to the WEST Unit is via Washburn Lk Rd and the ski trails. A short segment of old trail (A) will need to be opened up for access.

A temporary cable gate is to be installed on the north access by the Contractor. This gate, along with the existing gate on the south are to be closed at the end of each day and any time no one is working on site.

The ski/bike trails must be returned to their original condition or better at the end of each harvest season. Skidding on or across the single track bike trail must be kept to a minimum. No ruts or tire impressions shall be left on the trails. All limbs 1/2 dia or larger must be removed from the trails. Bond money will not be returned until all road/landing work is completed.

4. Extreme care must be taken to protect the ski and bike trails. The single track bike trails must be kept completely clear of all debris (ALL slash) at the end of each day and at the end of the sale. The trails within and adjacent to the sale boundary will be closed down by the Ski/Bike Club during harvesting operations. A minimum of 3 days notice prior to starting operations must be given to the County by the Contractor to facilitate closing of the trails.

5. No equipment, skidding, decking or slash is permitted in the lowland areas within or adjacent to the sale. No equipment may be operated within 15 ft of any wetland unless ground is dry or frozen to prevent rutting. All slash must be cut to no higher than 2' off the ground on the entire sale. Where possible, slash is to be pulled a minimum of 10 ft from the single track trails and 25 ft from the ski trails.

6. BMP's must be followed on all aspects of the sale.

7. All terms of the Timber Sale Contract also apply.

Sale Est: PF/ER/JR 9/17