

Oneida County Forest

Tract #17-17
Town of Lynne

Powerfly Hardwood

Compartments/Stands:

103/4, 103/5, 103/12, 103/13

Sale Area: 145 Acres (Includes 3 reserve acres)

T37N R4E Sec.17 SW, S1/2SE

Sec.20 N1/2NW, SENW, NWNE

Approximate
Sale Location



Contractor: _____
Contract # _____
Date Sold: _____
Date Completed: _____
2 Year Contract

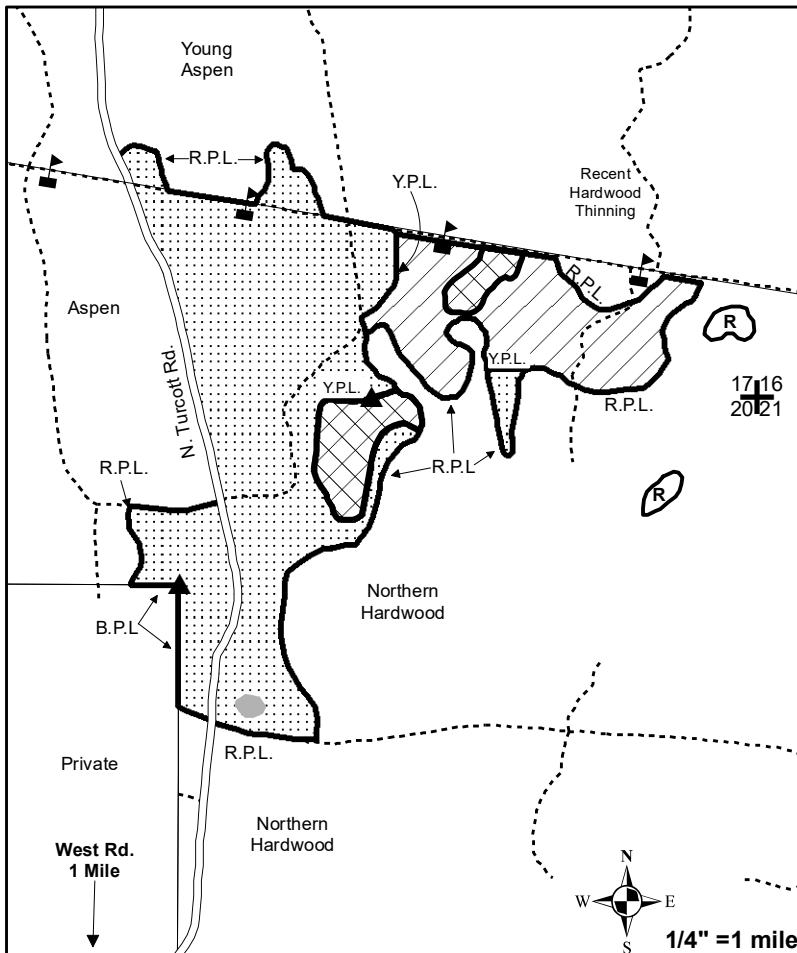

4" Top	Est. Vol.	Min. Bid
Mixed Hardwood*	2495 Tons (1037 cd)	\$12.70/T
Aspen	730 Tons (325 cd)	\$12.10/T
Basswood	400 Tons (207 cd)	\$2.90/T
Balsam Fir	100 Tons (46 cd)	\$4.40/T

Mixed Hardwood* = 31% ash, 36% hard maple, 24% red maple and 9% white birch.

Whole Tree	Est. Vol.	Min. Bid
Mixed Hardwood*	3585 Tons (1491 cd)	\$8.84/T
Aspen	1015 Tons (450 cd)	\$8.70/T
Basswood	585 Tons (302 cd)	\$1.98/T
Balsam Fir	175 Tons (82 cd)	\$2.51/T

Mixed Hardwood* = 31% ash, 36% hard maple, 24% red maple and 9% white birch.

Sawtimber	Est. Vol.	Min. Bid
Mixed Hardwood^	60 MBF	\$155.00/MBF
Basswood	40 MBF	\$118.00/MBF
Hard Maple	8 MBF	\$258.00/MBF

Mixed Hardwood^ = 77% ash, 14% red maple and 9% white birch.

Legend

	Clearcut with Reserves		Powerline
	Hardwood Thinning		R.P.L. Red Paint Line
	Grass Opening		Y.P.L. Yellow Paint Line
	Swamp Hardwood		B.P.L. Blue Paint Line
	Town Road		Section Corner
	Logging Roads		Survey Monument
	Reserve Areas		

Additional Regulations:

1. In hardwood thinning unit, harvest all 1" dbh (diameter at breast height) and larger aspen, ironwood, and balsam fir along with all orange marked trees. Leave all cherry, yellow birch, spruce, oak and cedar. No aspen may be harvested within 50 feet of the grass opening located in the southern end of the sale.

In clearcut with reserves and swamp hardwood unit, harvest all 1" dbh and larger aspen, ironwood, balsam fir, basswood, white birch, red maple and hard maple along with ash 8" dbh and larger. Leave all cherry, yellow birch, spruce, oak, cedar and ash smaller than 8" dbh.

Utilization on all species is a 100" stick to a 4" top or whole tree. If harvesting whole tree, 1 in 10 tops above the standard 4" diameter must be left evenly scattered in the harvest areas. Standing dead trees are not to be cut unless they pose a safety hazard.

2. Logging operations are limited to the period from July 15 to spring break up and only when ground is dry or frozen to prevent rutting. Due to drainage crossings within the clearcut with reserves unit, frozen ground and/or timber mats may be required to cross. Additional time restrictions may be imposed if excessive rutting occurs in the woods, on the roads or if excessive damage to the residual trees occur. If, in the opinion of the County, excessive damage to the residual stand cannot be avoided by the contractor, additional harvesting restrictions will be imposed or the contract may be cancelled.

3. Any trees felled across blue paint lines must be pulled back into the cutting area before limbing and bucking. All survey markers and bearing trees have been painted with blue paint and must be left intact.

4. All trails and landings must have approval of the County prior to construction. Following completion of the sale, all trails will be returned to their original condition or better. All access roads will be rocked or bermed off at the end of each harvest season and at the end of the sale. Private driveway may be used but must be restored to original condition or better and be maintained in a safe, travelable condition throughout the duration of the sale. Bond money will not be returned until all road work is completed. Existing grassy openings within the sale may be used for landings. Grassy openings must be leveled and clear of debris upon completion of sale operations.

5. No equipment or slash is allowed within wetland areas except at crossings. Slash must be removed upon completion of the sale.

6. All slash must be cut to less than 2 ft high within 50 ft of N. Turcott Rd and must be pulled back 25 ft from the road. Decking on N. Turcott Rd may be allowed with permission from the town of Lynne. Wood decked along the road must be far enough off the road so as not to create a hazard to motor vehicles. Any damage to the road will be repaired by the contractor including grading and graveling if necessary.

7. Stump height may not exceed 10".

8. All items listed in the Oneida County Timber Sale Contract apply. All applicable BMP's will be followed.

Sale Est.:JR, PF, JL, JB 8/17