

Oneida County Forest Bigger Burrows North

Compartment / Stand 56/1, 3, 7
 Harvest Area: 250 Ac + 14 Ac Reserve
 Legal Desc. T37N R5E Sec. 33 N1/2 Sec. 34
 NWSW, NESW, NWSE, SWNE, NW1/4



Tract # 16-17
 Town of Little Rice
 Contract No.: _____
 Contractor: _____
 Date Sold: _____
 Date Completed: _____
 Contract Length: 4 years

4" Top	Est. Volume	Min. Bid
Aspen	6500 Tons (2889 cd)	\$10.70/Ton
MX Hardwood (MX Hardwood contains approximately 78% Red Maple, 21% W Birch and 1% Bl Ash)	5100 Tons (2082 cd)	\$8.20/Ton
Balsam Fir	2250 Tons (1056 Cd)	\$2.50/Ton
Tamarack	330 Tons (142 Cd)	\$8.40/Ton
Bl Spruce	875 Tons (438 Cd)	\$8.40/Ton
<hr/>		
Sawlogs	Est. Volume	Min. Bid
Mx Hwd (Mx Hwd Logs: 84% R Maple, 16% W Birch)	56 MBF	\$123.00/MBF

WHOLE TREE	Est. Volume	Min. Bid
Aspen	8725 Tons (3878 cd)	\$7.97/Ton
MX Hardwood (MX Hardwood contains approximately 78% Red Maple, 21% W Birch and 1% Bl Ash)	7040 Tons (2873 cd)	\$5.90/Ton
Balsam Fir	4485 Tons (2105 Cd)	\$1.25/Ton
Tamarack	470 Tons (202 Cd)	\$5.90/Ton
Bl Spruce	1410 Tons (705 Cd)	\$5.21/Ton
<hr/>		
Sawlogs	Est. Volume	Min. Bid
Mx Hwd (Mx Hwd Logs: 84% R Maple, 16% W Birch)	56 MBF	\$123.00/MBF

SEE MAP PAGE 2

NOTE: Call the Oneida county Forestry Office (715)369-6140 for the key to open the pit gate for access to this timber sale.

Harvest Regulations

1. In the **Black Spruce (10 Ac) and Tamarack Areas (8 Ac)**, harvest all Black Spruce, Tamarack, Aspen, Maple, Cherry, Black Ash, White Birch and Balsam Fir LARGER than 1" diameter breast height (DBH). Do NOT harvest any Green-Marked trees. WT harvesting is not allowed here.

Tops and limbs shall be used as travel mats in these wetter areas.

In the **Aspen Area (232 Ac)** Harvest all aspen, red maple, sugar maple, white birch, white ash, white spruce, tamarack, black spruce, cherry, ironwood and balsam fir greater than 1inch DBH. Harvest all merchantable (5"+) black ash. WT harvesting is allowed here. There are many small areas, usually less than an acre, in the aspen area that requires "leaving" 3-5 dominant 5+inch diameter black spruce or tamarack every 100 feet or at least one clump minimum in the middle of that black spruce pocket as a seed source.

Utilization on all species is a 100" stick to a 4" top. Any den or nest trees shall be left uncut. Standing dead trees are not to be cut unless they pose a safety hazard.

If utilizing WHOLE TREE (Aspen area ONLY), every 10th tree top above the standard 4' top diameter must remain in the woods and evenly distributed, as much as possible.

No equipment or slash is allowed in the streams or adjacent and within timber sale boundary kegs or over the Blue Paint Line.

2. Year-round harvesting may occur in the aspen stand as long as the ground is frozen or dry to prevent rutting. Frozen ground conditions are required for the black spruce, tamarack, far west aspen area(5 acres) and low ground spruce areas within the aspen stand.

3. All landings and roads must have approval of the County prior to construction. Following completion of the sale, all trails and landings will be returned to their original condition or better. All new access roads will be bermed off or blocked with boulders at the completion of each harvest season and at completion of the sale. Bond money will not be returned until all road work is completed.

4. Slash must be pulled back a minimum of 10' from the main access logging road and shall be cut to within 2' of the ground in this area. No other slash treatment is needed outside the 10' road zone.

5. Stump height shall not exceed 10" within the entire sale area.

6. A waterway permit will be acquired by the County to cross the Brown Creek tributary. A temporary bridge may be rented from the Oneida County land Conservation Department 715-369-7835, if needed and scheduled accordingly.

7. All items listed in the Oneida County Timber Sale Contract apply. All applicable BMP's will be followed. Sale Est. PF/JR/ER 9/2017

Oneida County Forest Bigger Burrows North

Compartment / Stand 56/1, 3, 7
Harvest Area: 250 Ac + 14 Ac Reserve
Legal Desc. T37N R5E Sec. 33 N1/2
Sec. 34 NWSW, NESW,
NWSE, SWNE, NW1/4

28 27
+
33 34

Approximate Sale
Location

DNR

Tract # 16-17

Town of Little Rice

Contract No.:

Contractor:

Date Sold:

Date Completed:

Contract Length: 4 years

**SEE REGULATIONS
PAGE 1**

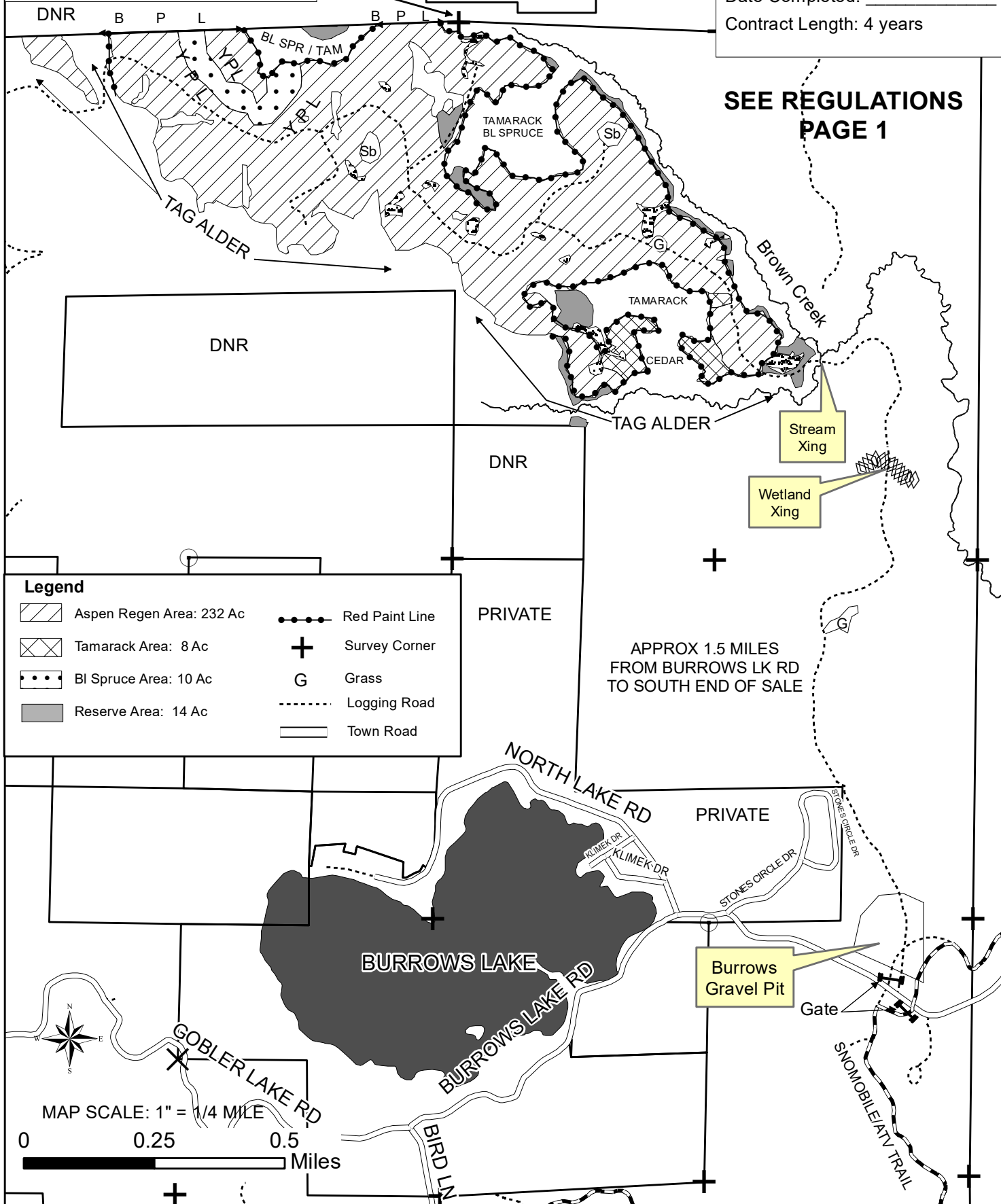

Legend

- | | |
|--------------------------|----------------|
| Aspen Regen Area: 232 Ac | Red Paint Line |
| Tamarack Area: 8 Ac | Survey Corner |
| Bl Spruce Area: 10 Ac | Grass |
| Reserve Area: 14 Ac | Logging Road |
| | Town Road |

PRIVATE

PRIVATE

BURROWS LAKE

Burrows
Gravel Pit

Gate

SNOBILEATV TRAIL

MAP SCALE: 1" = 1/4 MILE

0 0.25 0.5 Miles