

# Oneida County Forest Langlois Forty

Tract # 26-16 NCF

Town of Lynne

Contract No.: \_\_\_\_\_

Contractor: \_\_\_\_\_

Date Sold: \_\_\_\_\_

Date Completed: \_\_\_\_\_

Compartment/Stand 97/15 & 97/16  
 19 acres Aspen Regen  
 8 acres Marked Thinning  
 2 Acres GTR  
 Legal Desc. T37N R4E Sec. 29 S1/2 NW

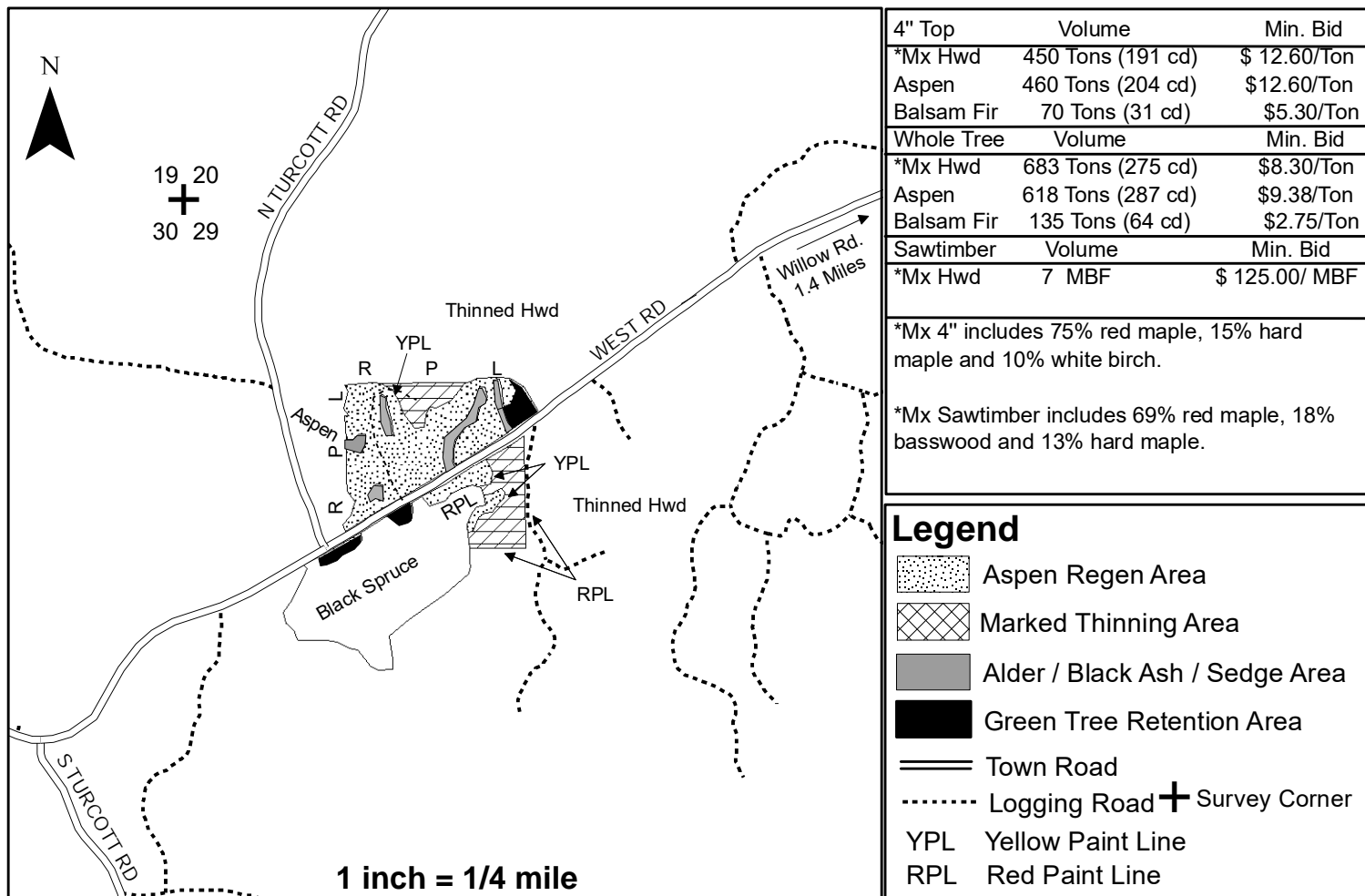

### Additional Regulations

1. In the aspen clearcut area, harvest all stems 1" and larger except yellow birch, oak, pine, cherry, elm, tamarack, cedar and spruce.  
 In the marked thinning area, harvest all white birch, aspen, balsam and ironwood 1" and larger and all trees marked with orange paint. In the Purple painted gaps, harvest all trees 1" dia and larger except Oak and cut the purple painted trees.  
 Utilization on all species is a 100" stick to a 4" top or whole tree. If harvesting whole tree, every 10th tree top above the 4" diameter must be left evenly scattered in the harvest area. Any den or nest trees shall be left uncut. Standing dead trees are not to be cut unless they pose a safety hazard.
2. Operations in the Hardwood thinning are restricted to July 15 through March 15 (spring breakup) to prevent damage to residual trees. Operations in the Aspen Regen are allowed year round as long as the ground is dry or frozen to prevent rutting. Additional time restrictions may be imposed if excessive rutting occurs in the woods or on the roads or if excessive damage to the residual trees occurs. If, in the opinion of the County, excessive damage to the residual stand cannot be avoided by the Contractor, additional harvesting restrictions will be imposed or the Contract may be cancelled.
3. All landings and roads must have approval of the County prior to construction. An existing logging road to the east of the sale and south of West Road may be used for harvesting and hauling operations per the specifications of this contract. Following completion of the sale, all trails and landings must be returned to their original condition or better. Any new access roads must be bermed off or blocked with boulders at the completion of each harvest season and at completion of the sale. Bond money will not be returned until all road work is completed.
4. No skidding or decking permitted on West Road without permission of the Town of Lynne.
5. No equipment may be operated within 15 feet of the wetland areas adjacent to or within the sale unless ground is frozen. No slash may be left within wetland areas and no equipment or slash will be permitted within the green tree retention areas. Slash must be pulled back a minimum of 25' from West road and all slash within 50' of West road shall be cut to no higher than 2' above the ground. Stump height may not exceed 10" within the entire sale area.
6. All items listed in the Oneida County Timber Sale Contract apply. All applicable BMP's will be followed.

Sale Est. ERR/AJ/PF 9/16