

# Oneida County Forest Hintz Lamers 2

Compartment / Stand 106/5, 108/1, 30, 31  
 Harvest Area 118 acres + 6 Ac Reserve (124 Ac Total)  
 Legal Desc. T37N R4E Sec. 22 S1/2NE,  
 N1/2SE, SWSE  
 Sec. 23: S1/2NW, SWNE, N1/2SW,  
 Sec. 27: NWNE, NENW

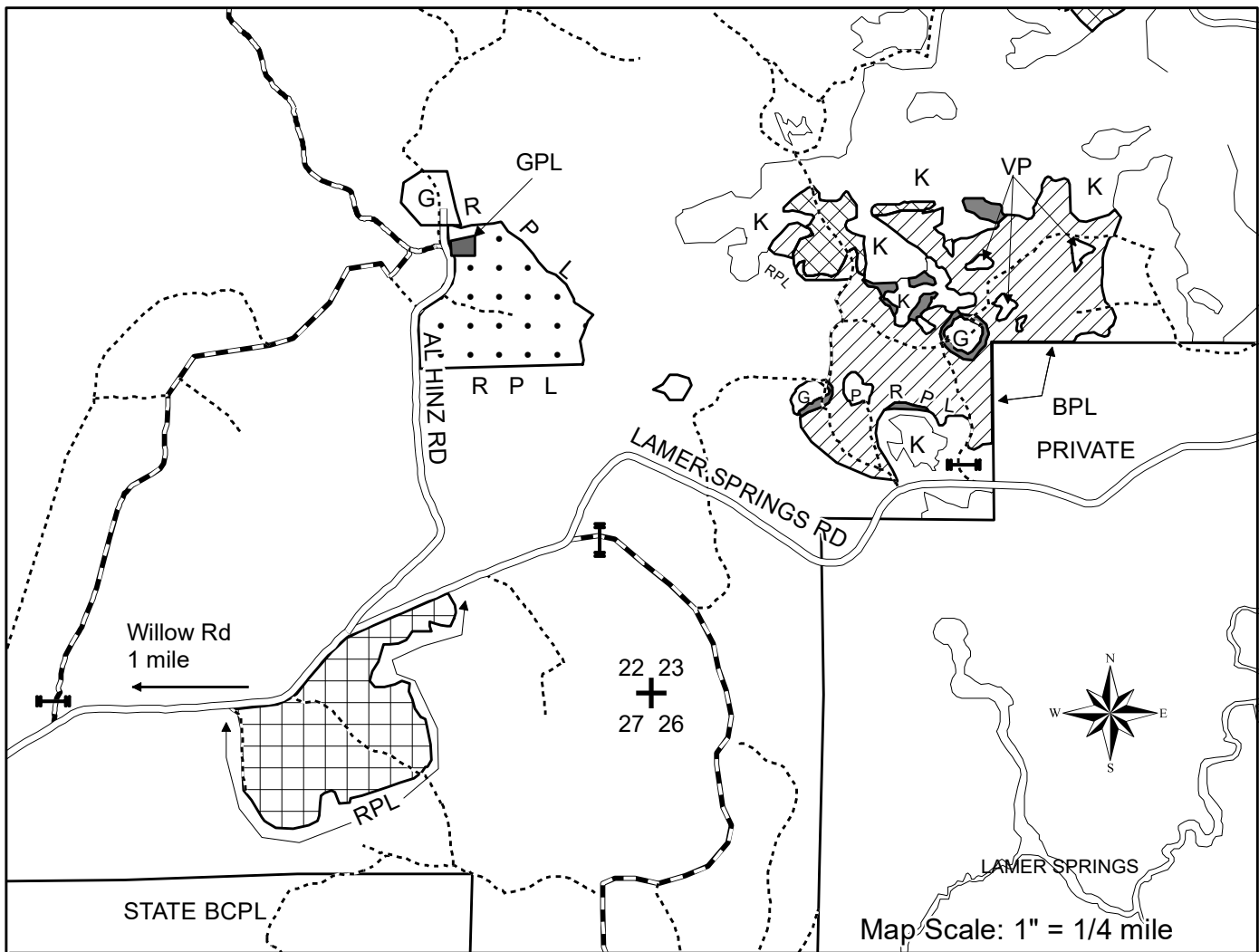

Tract # 7-17  
 Town of Lynne  
 Contract No.: \_\_\_\_\_  
 Contractor: \_\_\_\_\_  
 Date Sold: \_\_\_\_\_  
 Date Completed: \_\_\_\_\_  
 Contract Length: 2 years



| <b>Legend</b> |                        |     |                  |    |                               |
|---------------|------------------------|-----|------------------|----|-------------------------------|
|               | Aspen Regen Area       | RPL | Red Paint Line   |    | Old Logging Road / Skid Trail |
|               | Marked Pine Area       | BPL | Blue Paint Line  | K  | Keg/Wetland                   |
|               | Marked Thinning Area   |     | Town Road        | P  | Thinned Pine                  |
|               | Overstory Removal Area |     | Gate             | G  | Grass Opening                 |
|               | Reserve Area           |     | Snowmobile Trail | VP | Vernal Pond                   |
|               |                        |     |                  | +  | Survey Corner                 |
|               |                        |     |                  |    | GPL                           |
|               |                        |     |                  |    | Green Paint Line              |

| 4" Top   | Est. Volume        | Min. Bid     |
|--|--------------------|--------------|
| Aspen  | 2155 Tons (958 cd) | \$11.40/Ton  |
| *MX Hardwood   | 1265 Tons (516 cd) | \$11.40/Ton  |
| Balsam Fir   | 135 Tons (63 cd)   | \$4.80/Ton   |
| R Pine   | 135 Tons (60 cd)   | \$16.20/Ton  |
| *MX Hardwood 4" and whole tree contains approximately 45% Sugar Maple, 20% Red Maple, 34% W Birch and 1% Ash |                    |              |
| Sawlogs  | Est. Volume        | Min. Bid     |
| **MX Hardwood  | 9 MBF              | \$135.00/MBF |
| **MX Hardwood sawtimber contains approximately 34% White Ash, 23% Red Maple, 28% W Birch and 16% H Maple     |                    |              |

| Whole Tree   | Est. Volume         | Min. Bid     |
|--|---------------------|--------------|
| Aspen  | 2935 Tons (1304 cd) | \$8.37/Ton   |
| *MX Hardwood   | 1880 Tons (767 cd)  | \$7.67/Ton   |
| Balsam Fir   | 195 Tons (92 cd)    | \$3.32/Ton   |
| R Pine   | 205 Tons (91 cd)    | \$10.67/Ton  |
| *MX Hardwood 4" and whole tree contains approximately 45% Sugar Maple, 20% Red Maple, 34% W Birch and 1% Ash |                     |              |
| Sawlogs  | Est. Volume         | Min. Bid     |
| **MX Hardwood  | 9 MBF               | \$135.00/MBF |
| **MX Hardwood sawtimber contains approximately 34% White Ash, 23% Red Maple, 28% W Birch and 16% H Maple     |                     |              |

# Oneida County Forest Hintz Lamers 2

Compartment / Stand 106/5, 108/1, 30, 31  
 Harvest Area 118 acres + 6 Ac Reserve (124 Ac Total)  
 Legal Desc. T37N R4E Sec. 22 S1/2NE,  
 N1/2SE,SWSE  
 Sec. 23: S1/2NW, SWNE, N1/2SW,  
 Sec. 27: NWNE, NENW



Tract # 7-17  
 Town of Lynne  
 Contract No.: \_\_\_\_\_  
 Contractor: \_\_\_\_\_  
 Date Sold: \_\_\_\_\_  
 Date Completed: \_\_\_\_\_  
 Contract Length: 2 years

| 4" Top  | Est. Volume         | Min. Bid     |
|---|---------------------|--------------|
| Aspen   | 2155 Tons (958 cd)  | \$11.40/Ton  |
| *MX Hardwood  | 1265 Tons (516 cd)  | \$11.40/Ton  |
| Balsam Fir  | 135 Tons (63 cd)    | \$4.80/Ton   |
| R Pine  | 135 Tons (60 cd)    | \$16.20/Ton  |
| *MX Hardwood 4" and whole tree contains approximately 45%<br>Sugar Maple, 20% Red Maple, 34% W Birch and 1% Ash |                     |              |
| Whole Tree  | Est. Volume         | Min. Bid     |
| Aspen   | 2935 Tons (1304 cd) | \$8.37/Ton   |
| *MX Hardwood  | 1880 Tons (767 cd)  | \$7.67/Ton   |
| Balsam Fir  | 195 Tons (92 cd)    | \$3.32/Ton   |
| R Pine  | 205 Tons (91 cd)    | \$10.67/Ton  |
| Sawlogs   | Est. Volume         | Min. Bid     |
| **MXHardwood  | 9 MBF               | \$135.00/MBF |
| **MX Hardwood sawtimber contains approximately 34% White<br>Ash, 23% Red Maple, 28% W Birch and 16% H Maple     |                     |              |

## SEE MAP PAGE 2

**Additional Regulations**

1. In the **Aspen Regen** area: Harvest all Aspen, Maple, Balsam Fir and White Birch not marked with green paint. All trees of these species 1" dia and larger must be cut. Year round harvesting is permitted as long as the ground is dry or frozen to prevent rutting. The Aspen area is surrounded by red paint line on all sides except at the blue paint line in the southeast corner.

In the **Marked Pine** areas, harvest all Red Pine marked with orange paint. Harvest all aspen, White Birch, maple and balsam within the pine stands. Harvesting is permitted year round as long as the ground is dry or frozen to prevent rutting. All pine harvested between April 1 and Aug 15 must be skidded and hauled within 2 weeks of cutting.

In the **Marked Thinning** Area: Harvest all Aspen, Balsam Fir 1" dia and larger, and only those hardwoods marked with orange paint. Harvesting activities are limited to July 15 through March 15 (spring breakup) and only when the ground is dry or frozen to prevent rutting.

In the **Overstory Removal** Area; Harvest all Maple, W Birch, Ash and Balsam Fir 1" dia or larger. Do not cut or damage Aspen, Oak, Pine or Spruce. To protect the hardwood regeneration present on this area the following regulations will be enforced: Harvesting is only permitted during times of frozen ground. This area must be cut using either a fixed head harvester or by hand. Processor shall fall trees in the direction of travel to the extent possible. Only shortwood forwarding allowed. Forwarder must follow the same path as the processor to the extent possible.

2. Utilization is 100" stick to a 4" top or whole tree. If harvesting whole tree, every 10th top above the standard 4" top shall be left evenly scattered throughout the sale area.

3. Slash is to be pulled back from the town roads a minimum of 25 and cut to no higher than 2 ft from the ground within that zone. Slash control outside the 25 ft zone is not required.

4. No new roads permitted. Existing roads may be improved and landings and turn-arounds constructed with prior approval of the County. All roads must be leveled, and if they were blocked off prior to the sale they must be blocked with rocks, a berm or gate at the end of each harvesting season and at the end of the sale. The grass openings may be used for landings and must be completely clear of slash and leveled to facilitate mowing at the end of each harvest season and at the end of the sale. Do not cut any aspen within 50 ft of the grass openings. Part of Lamer Springs Rd is a snowmobile trail. Cautionary signs must be posted on both ends of the sale if harvesting/hauling during snowmobile season.

5. No equipment is allowed to operate within 15 ft of any wetland or vernal pond within or adjacent to the sale unless the ground is dry or frozen. No slash is to be left in any wetland or vernal pond. No equipment or slash is allowed within the reserve areas.

6. All dead standing trees in all areas must be left standing unless they pose a safety hazard to the harvesting operations.

7. All items listed in the Oneida County Timber Sale Contract apply. All applicable BMP's will be followed. Sale Est. AJ/PF/MO 3/17