

Oneida County Forest

Willow Falls Forgotten Pine

CMPT/ STAND: 108 /4
 CUTTING AREA: 49 ACRES
 DESCRIPTION: T37N R4E,
 SEC. 14: SE1/4, NESW, S1/2NW
 SEC 23: NWNE



Tract # 6-17
 Town of Lynne
 Contract No.: _____
 Contractor: _____
 Date Sold: _____
 Date Completed: _____
 Contract Length: 2 years

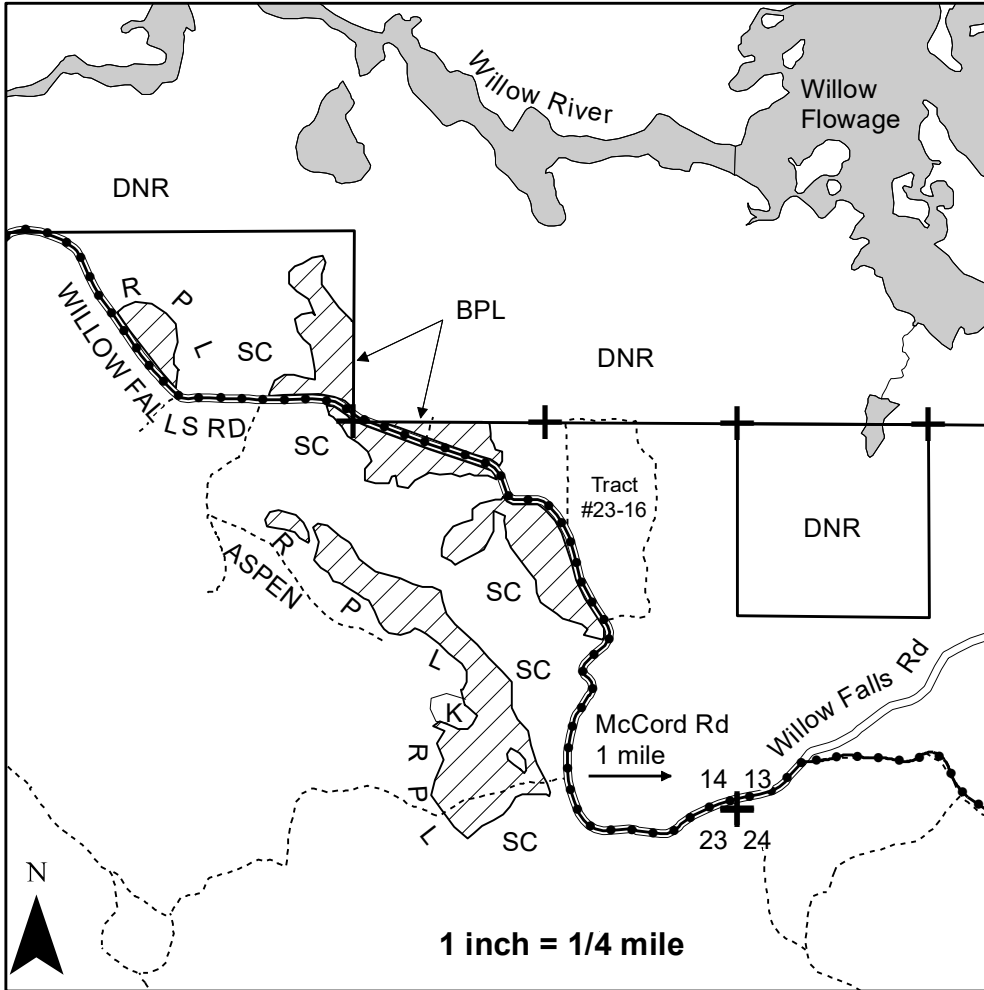

4" Top	Est. Volume	Min. Bid
Red Pine	1650 Tons (730 cd)	\$28.20/Ton
Red Pine contains 97% R Pine, 2% W Pine and 1% W Spruce		

Legend

- Marked Pine
- Town Road
- Old Logging Road / Skid Trail
- Survey Corner
- RPL Red Paint Line
- BPL Blue Paint Line
- SC Swamp Conifer
- K Keg
- Snowmobile/ATV Trail

Additional Regulations:

- a. In the Marked Pine Area: Harvest all trees marked with orange paint. Utilization is 100" to a 4" top. Snags must remain standing unless they are a safety issue for the harvesting operation.
- b. No decking of pine products for more than 2 weeks between April 1st and September 15th. Logging operations are allowed year round as long as the ground is dry or frozen to prevent rutting.
- c. Decking or skidding on or across Willow Falls Rd must have prior approval of the Town of Lynne. If decking or skidding occurs on Willow Falls Rd, all wood must be decked far enough off the road to prevent a safety hazard to vehicle traffic. Willow Falls Rd is a designated Snowmobile and ATV trail. Cautionary signs must be placed at either end of the sale during all operations.
- d. No whole tree skidding allowed. If damage occurs to residual stand further skidding restrictions may be imposed (shortwood only or winter only) or the contract may be cancelled. Utility poles must be skidded after all other marked trees are harvested.
- e. All slash must be pulled back 25 feet from Willow Falls Road and must be cut to lie less than 2 feet off the ground. No other slash requirements will be required on the remainder of the sale.
- f. Any trees felled across the blue line or into a wetland areas either within the sale or adjacent to the sale must be pulled back onto high ground before limbing and bucking occurs. No equipment will be allowed to operate in any wet areas within or adjacent to the timber sale unless ground is frozen.
- g. All applicable BMP's must be followed during all phases of the sale.
- h. Access is limited to current logging road system. Landing sites must have County Forestry Dept approval. All roads and landings must be leveled and free of slash at the end of each harvest season and at sale completion. Any trails opened for access must be bermed or rocked to prevent vehicle traffic at the end of each harvest season and at the end of the sale. Bond money will not be returned until all trail rehabilitation is complete.
- i. All items of the Oneida County Timber Sale Contract also apply.

EST: WOD DNR 12/16

NOTE:Heterobasidion (Annosum) Root Rot preventative spraying requirements will be implemented if Heterobasidion (Annosum) Root Rot is found in Oneida County or an adjacent county prior to or during the period of this contract. See Timber Sale Contract for details.